

# Simplified management of solar and storage systems

## Conext™ Gateway

Introducing a powerful new control solution that provides local system configuration and management as well as live system monitoring for the residential and commercial range of solar and storage products



### Solution at a glance

The new Conext™ Gateway provides local system configuration and management as well as live system monitoring for the residential and commercial range of solar products.

To accelerate the installation and system setup process, the Conext™ Gateway offers wireless connectivity along with more intuitive configuration and system management tools. To give users better insights into your solar system performance, the Conext™ Gateway's graphing and reporting interfaces are completely updated.

The Conext™ Gateway together with Conext™ Insight 2 will bring system monitoring and remote management to the cloud.

The Conext™ Gateway is compatible with the new Conext™ XW Pro and the rest of the residential and commercial range of solar and storage products.

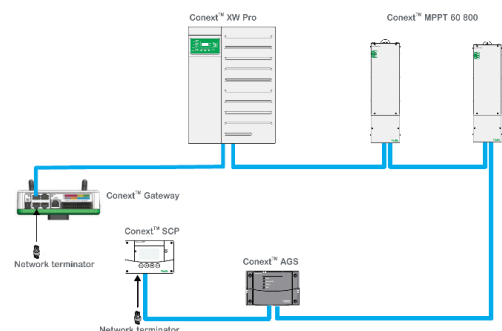

# Conext™ Gateway

Advanced diagnostics for solar and battery systems

## Higher return on investment

- Monitor solar system performance in real time on your local network
- Monitor your system from anywhere using Conext™ Insight 2
- Measure and compare energy performance over varying time frames

## Flexible

- Multiple visualizations for trend analysis as well as custom data logging for diagnostics
- Built-in wireless access point (WAP) connectivity for easy configuration (wirelessly connect a laptop to your Gateway)
- Built-in wireless station mode for connection to a local area network
- Dual Xanbus channels to support larger networks of devices
- Modbus support for string inverters and third-party Modbus devices\*
- Canbus for compatible storage systems (e.g., Li-ion batteries)\*

## Easy to service

- View or download an events log for faster troubleshooting
- Upgrade Conext™ Gateway and other Conext™ devices firmware through Gateway's web application
- Remotely manage system settings and firmware updates from Conext™ Insight 2\*

## Easy to install

- Configure devices remotely on the web
- Surface or DIN-Rail mounting options
- Multiple power supply options; AC adapter or Xanbus

\* This feature is in development as of November 21, 2019. Please contact your local sales representative for more information on features under development

## Applications



Rooftop for feed-in-tariff / net metering



Rooftop for self-consumption with storage



PV-Diesel hybridization



Storage / backup power

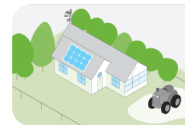

Commercial off-grid



Microgrids

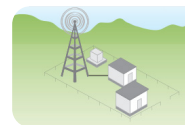

Telecom towers



Residential grid-tie solar with battery backup



Residential self-consumption with storage

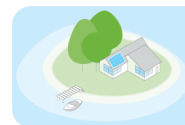

Residential off-grid



Residential backup power

# Technical Specifications

## Conext™ Gateway

|   |   |
|---|---|
| Device short name                       | Conext™ Gateway   |
| <b>Electrical Specifications</b>        |   |
| Power consumption                       | 2 W average / 10 W peak   |
| AC/DC adapter (supplied)                | Input: 100-240V AC, 50-60Hz, 0.6A,<br>Output: 12V DC, 1.5A, 5.5mm outer, 2.1mm center-positive jack |
| Xanbus                                  | When connected to Conext XW Pro / SW or MPPT 80 600 providing network power                         |
| 24V on 26-pin connector                 | 24V DC, 1A max input only through pins 1 and 2<br>Accepts 16 - 24 AWG pin wire size                 |
| <b>Physical Specifications</b>          |   |
| Part number                             | 865-0329  |
| Weight (device only)                    | 340 g / 0.75 lb   |
| Dimensions (device only) (W × H × D)    | 134 x 137.4 x 48.5 mm / 5.3 × 5.4 × 1.9 inches  |
| Shipping package dimensions             | 158 × 158 × 188 mm / 6.2 × 6.2 × 7.4 inches   |
| Shipping package weight                 | 2 kg / 4.5 lb   |
| Housing / Mounting system               | ABS Plastic / 35-mm DIN rail clip   |
| IP rating / Mounting Location           | IP 20, NEMA 1, Indoor only  |
| Status Display                          | 7 x LEDs  |
| Temperature                             | Operating: -4 to 122 °F / -20 to 50 °C<br>Storage: -40 to 185 °F / -40 to 85 °C                     |
| Humidity                                | Operating: < 95%, non-condensing<br>Storage: <95%   |
| <b>Features</b>                         |   |
| Programmable dry contact relay          | Screw 3-terminal, 16-24 AWG, NC-Com-NO, Form: Class 2, 24 V DC, 4 A max SELV input only             |
| Graphical user interface                | Internet Browser  |
| Remote firmware upgrades                | Yes (Conext Gateway and connected Xanbus devices)   |
| Custom Data logger                      | Yes   |
| Max. number of Xanbus devices           | Up to 20 (depending on the device type)   |
| Micro-SD card (supplied)                | Read-only   |
| <b>Regulatory</b>                       |   |
| EMC immunity                            | EN61000-6-1   |
| EMC emissions                           | EN61000-6-3, FCC Part 15 Class B, Ind. Canada ICES-003 Class B                                      |
| Substances / environmental              | RoHS  |
| <b>Compatible products part numbers</b> |   |
| Conext XW Pro UL (120/240 V)            | 865-6848-21   |
| Conext XW+ IEC (230 V)                  | XW+ 8548 E: 865-8548-61   |
| Conext XW+ UL (120/240 V)               | XW+ 6848 NA: 865-6848-01  |
| Conext SW IEC (230 V)                   | SW 4024: 865-4024-55 / SW 4048: 865-4048-55   |
| Conext SW UL (120/240 V)                | SW 4024: 865-4024-21 / SW 4048: 865-4048-21   |
| Conext CL-60 E                          | PVSCL60E  |
| Conext CL36 IEC                         | PVSCL36E  |
| Conext MPPT 80 600                      | 865-1032  |
| Conext MPPT 60 150                      | 865-1030-01   |
| Conext System Control Panel             | 865-1050-01   |
| Conext Automatic Generator Start        | 865-1060-01   |
| Conext Battery Monitor                  | 865-1080-01   |

Specifications are subject to change without notice.



For indoor use only