

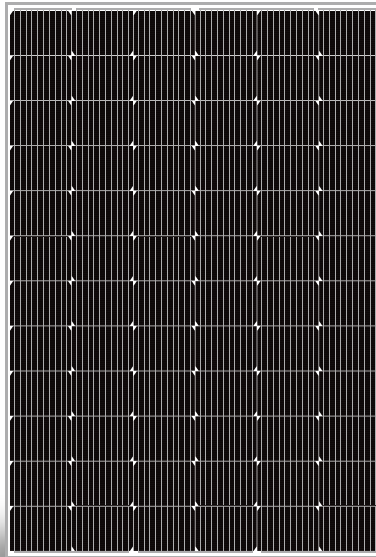

# ST-395Q-24CID2-QC

## High Efficiency Monocrystalline PV Module

- Nominal 24V DC for standard output.
- Outstanding low-light performance.
- Heavy-duty anodized frames.
- High transparent low-iron, tempered glass.
- Designed to withstand high wind pressures, hail and heavy snow.
- Quality aesthetic appearance.



272637  
CLASS I, DIVISION 2,  
GROUPS A, B, C AND D



**10** years

Product Warranty

**25** years

Power Warranty



### Industry Compliant

This CID2-rated solar panel is suitable for industries that are at risk of gas explosions, meeting NFPA and NEC safety standards



### Enhanced Safety

Equipped with specialized design elements, minimizing risk of ignition in hazardous environments, further adhering to CID2 certification standards



### Mechanical Robustness & Reliability

Engineered for durability and reliability, capable of operating efficiently even in volatile and hazardous conditions, where safety and efficiency matter most

## Performance Warranty

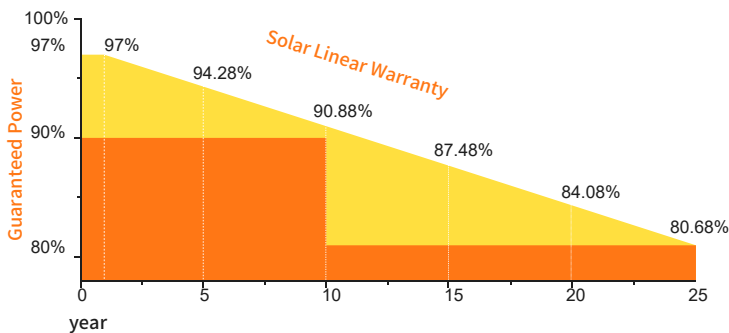

Wind Load/Snow Load:  
2400pa/5400pa

Positive Power Tolerance :  
3%

Warranty Information :  
10 Year Product Workmanship

### Specifications

<b>Cells</b>	Monocrystalline silicon solar cell
<b>No. of cells and connections</b>	72(6x12)
<b>Module dimension</b>	65.35in.x44.61in.x1.57in. [1660mmx1133mmx40mm]
<b>Weight</b>	45.79lbs[20.77kg]

### Rating Characteristics

<b>Operating temperature</b>	-40°C to 65°C
<b>Maximum system voltage</b>	600V DC
<b>Power tolerance</b>	0~± 3%
<b>Module Fire Performance</b>	Type 1 (for US)
<b>Fire Resistance Rating</b>	Class C (For Canada)
<b>PV module application class</b>	Class A
<b>Temperature code rating</b>	T3C

\*NOCT:Nominal operating cell temperature (the data is only for reference)

**Electrical Characteristics**

Module Type	ST-395Q-24CID2-QC
Maximum power (Pmax)	395W
Voltage at Pmax (Vmp)	41.94V
Current at Pmax (Imp)	9.42A
Open-circuit voltage (Voc)	47.69V
Short-circuit current (Isc)	9.91A
Module Efficiency	23.50%

\*STC: Irradiance 1000W/m<sup>2</sup>, AM1.5 spectrum, module temperature 25°C

**Temperature Characteristics**

Temperature coefficient of Voc	-(80±10)mV/°C
Temperature coefficient of Isc	(0.065±0.015)%/°C
Temperature coefficient of power	-(0.5±0.05)%/°C
NOCT (Air 20°C; Sun 0.8kW/m <sup>2</sup> wind 1m/s)	47±2°C

**I-V Curves (STC)**

ST-395Q-24CID2-QC

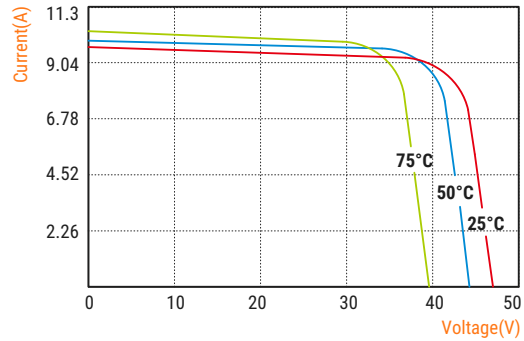

**Mechanical Diagrams**

ST-395Q-24CID2-QC

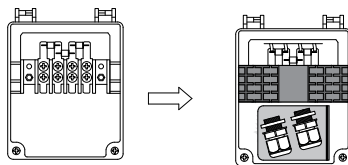
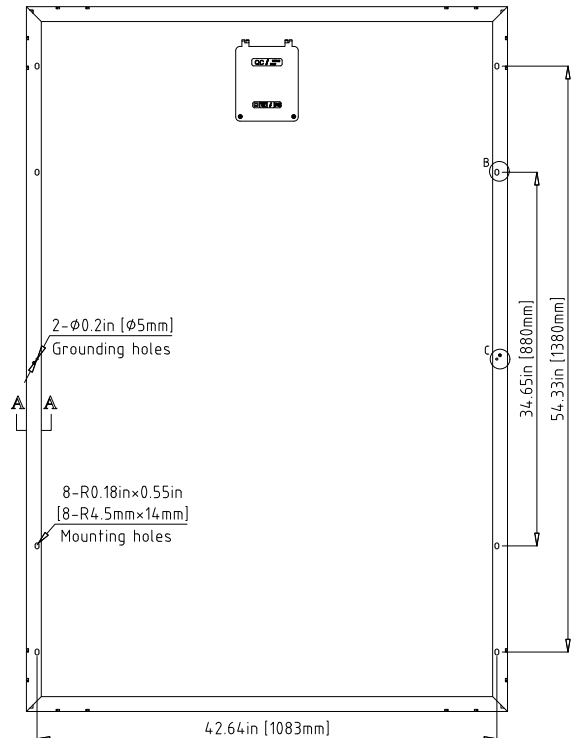
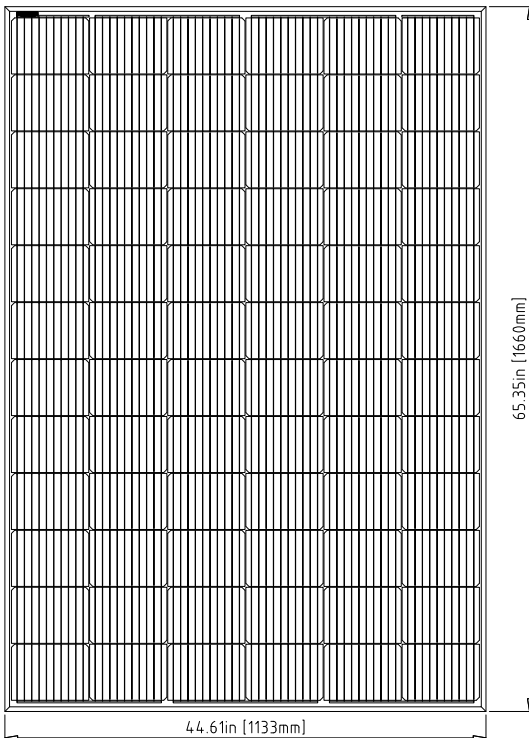

Junction Box  
Top View (Lid Open)

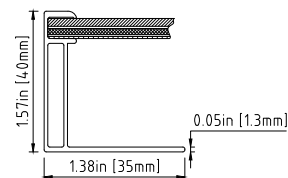

Section A-A